

4.0 Inch SIX-Digit Clock, 2.3  
Inch Seven-Digit Alphanumeric  
Date, Network NTP, POE, Flush  
Mount, 316L Stainless

[DC-25ALN-Date-406-Time-POE-STAINLESS-FLUSH](#)

**DC-Digital**  
tm



## Features

- Web browser-based interface & monitoring
- User selectable DHCP or Static IP (default DHCP)
- User selectable time zone & time format
- Acquires atomic NTP time & date from any server
- Time & date also shown on web page interface
- NEMA 4, 4X, 12, 13, IP-66, 316L, stainless enclosure
- .125" Closed cell foam XLPE gasket (standard)
- 2.3 Inch alpha-numeric date, 4.0-inch time LED's
- Time is visible up to 200 Ft, Date 120 Ft.
- PoE Ethernet RJ-45 connection
- Factory serviceable modular design
- Made in the USA

## Options

- Can be grouped; [DC-Webserver-Clocks-1](#)
- PE, Food Grade PE, EPDM, PTFE gaskets
- 2.3-inch LED time of day clock
- Surface mount 316L enclosure
- Aluminum flush & surface mount enclosures
- Network, non-POE (local power)
- POE injector
- Synchronized wireless data system

## Specifications

- **Input** POE (Power Over Ethernet), Data DHCP or Static IP NTP selectable
- **Display** 4.0 Inch Six-digit LED clock, 2.3 Inch digit red LED alpha-numeric display date
- **Case** Stainless SAE 316L, 25.9" W x 12.75" H x 1.56" D, with .125" XLPE closed cell foam gasketing material
- **Weight** 7.0 Pounds
- **Power Source** POE (802.3 AF Compliant) 500 mA, 6 Watts
- **Operating Temp** 0° to 49° Celsius (32° to 120° Fahrenheit)
- **Case Finish** Brushed 316L Stainless 2B finish
- **Cabling** RJ-45 Cat 5-6 connection into splitter (CE, Fcc compliant) on back side

## [DC-25ALN-Date-406-Time-POE-STAINLESS-FLUSH](#) Description

The DC-Digital [DC-25ALN-Date-40-Time-POE-STAINLESS-FLUSH](#) Atomic, network, date & time of day clock is designed to be used in any application where a 2.3 Inch 7-digit date and a larger 4.0-inch LED time of day clock (Hours, Minutes, and Seconds) with IP66 rated, gasketed, 316L flush mount enclosure (intended for regular disinfection and cleaning) is needed to be seen. It automatically queries NTP once every 1 minute (user selectable) and on power up. It can be set up for 12- or 24-hour time format (default is 12 Hour). It can be set up for static IP (default DHCP) to receive the NTP from your server (default is NIST). This unique design can be used in either existing buildings or new construction. The [DC-25ALN-Date-40-Time-POE-STAINLESS-FLUSH](#) date & time of day clock comes with all stainless flush mount enclosure with a gasket and polycarbonate lens, and 16 mounting points. This equipment is proudly made in the USA. This display is factory serviceable.

# DC-25ALN-Date-40-Time-POE-STAINLESS-FLUSH wall mounting and dimensions

There are (16) .240 diameter anchoring points.

Note: On thinner walls it is recommended using #10 screws:

For sheet metal screws use Fastenal # 0148063 or Timmerman # C8120-10-4 spring nuts

For machine screws use Fastenal # 0148061 or Timerman # C8115-1024-4 spring nuts

## DC-25ALN-DATE-406-TIME-FLUSH

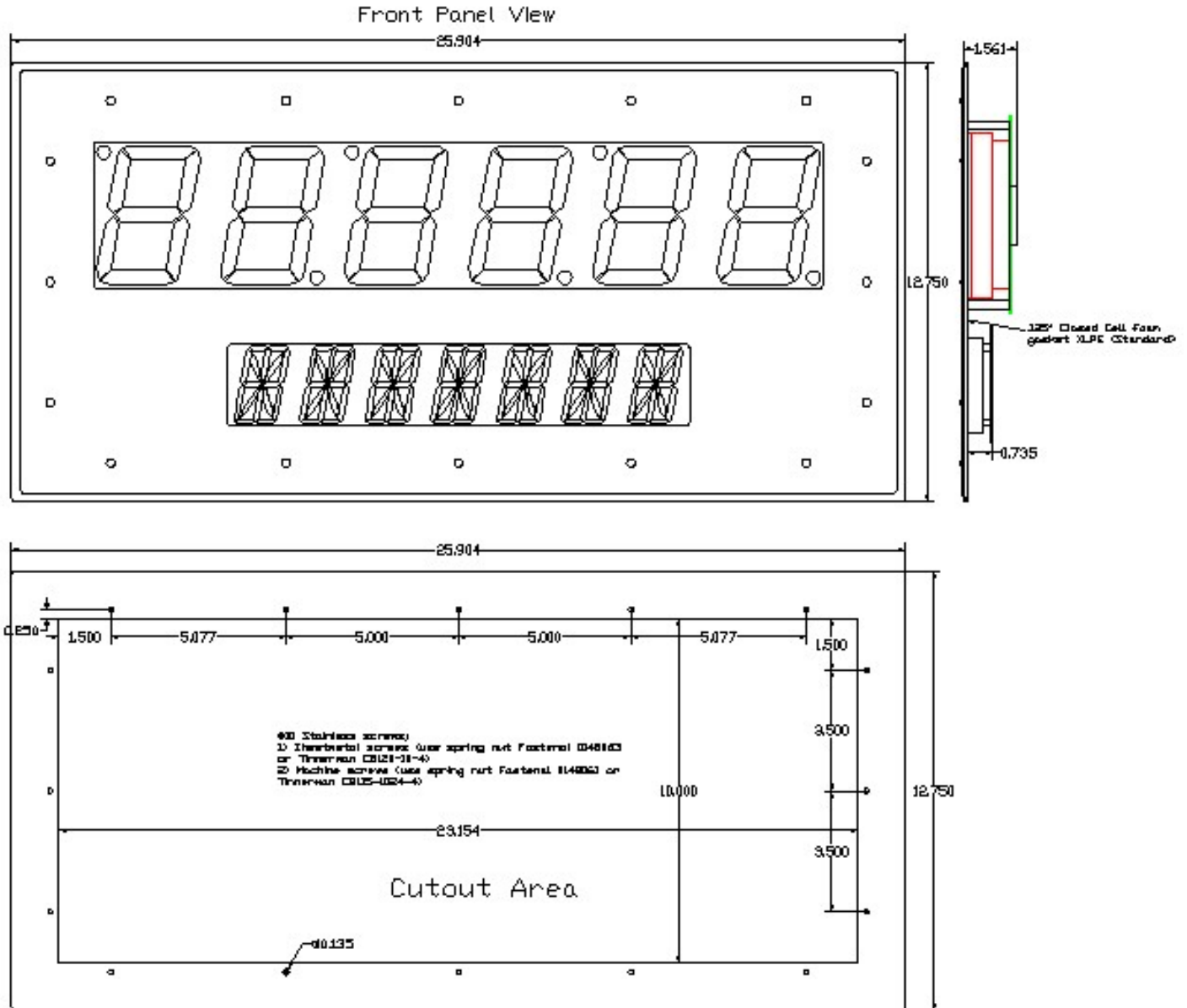

Optional Backbox:

DC-25ALN-DATE-406-TIME-FLUSH (Backbox)

Top / Bottom View

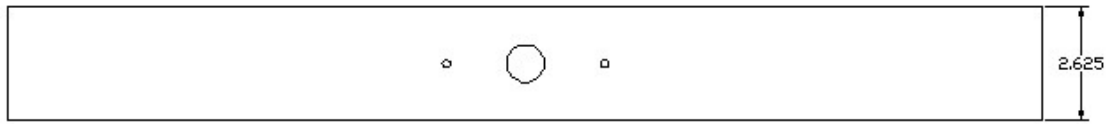

Backbox Body

L / R Side View

